

**FUNCTION**

The DOT 407 Magnetic Vacuum Breaker is a valve designed to limit negative pressure (vacuum) in a typical tank trailer.

A permanent magnetic force controls the movement of the valve poppet to open on demand of 4" Hg or greater. All working parts are kept away from the airflow paths, which promotes easy cleaning and hassle-free repairs. The valve body is cast with a 1" female port inlet to accept a variety of air inlet fittings. A 1/4" female port is standard to accept a gauge. The unit is equipped with either: a "Tef-O-Sil", Viton, or a Kalrez® O-Ring seal.



Viton, Teflon and Kalrez are standard. Special Elastomers are available upon request.

Styles	Description
<p><b>4030123T</b></p> <p>Gasket 3-TR</p> <p>These connection styles are tapped with a 1/4" gauge port and a 1" air accessory port as standard.</p>	<p>3" NPS Thread Designed to thread on a 3" Nipple. Swivels 360° for easy positioning.</p> <p>3X407MVBT-T Teflon® 3X407MVBT-K Kalrez® 3X407MVBT-V Viton®</p>
<p><b>4030123F</b></p> <p>Gasket 3CFE</p>	<p>3" TTMA Flange Designed to mount on a 3" TTMA Flanged Nozzle.</p> <p>3X407MVBF-T Teflon® 3X407MVBF-K Kalrez® 3X407MVBF-V Viton®</p>
<p><b>403012M</b></p> <p>1" Air Accessory Port.</p>	<p>Mitred Cut Designed to weld into a dome cover and conform to its curvature.</p> <p>407MVBLM-T Teflon® 407MVBLM-K Kalrez® 407MVBLM-V Viton®</p>
<p><b>403012S</b></p>	<p>Straight Stub Designed to weld to a domecover or tank shell.</p> <p>407MVBSL-T Teflon® 407MVBSL-K Kalrez® 407MVBSL-V Viton®</p> <p>These connection styles are tapped with a 1/4" gauge port and a 1" air accessory port.</p>
<p><b>403012F</b></p> <p>Gasket 4CFE</p>	<p>4" TTMA Flange Designed to mount on a 4" TTMA Flanged Nozzle.</p> <p>407MVBLF-T Teflon® 407MVBLF-K Kalrez® 407MVBLF-V Viton®</p>
<p><b>403012S</b></p> <p>Gasket 4TR</p>	<p>4" NPT Thread Designed to thread on a 4" Nipple. Swivels 360° for easy positioning.</p> <p>407MVBSL-T Teflon® 407MVBSL-K Kalrez® 407MVBSL-V Viton®</p>

**403012F**

4" TTMA Flange  
Designed to mount on a 4" TTMA Flanged Nozzle.

407MVBLF-T Teflon®  
407MVBLF-K Kalrez®  
407MVBLF-V Viton®

Gasket 4CFE

**403012S**

4" NPT Thread  
Designed to thread on a 4" Nipple. Swivels 360° for easy positioning.

407MVBSL-T Teflon®  
407MVBSL-K Kalrez®  
407MVBSL-V Viton®

Gasket 4TR

© Kalrez is a Registered Trademark of Dupont Dow Elastomers. | © Teflon is a Registered Trademark of Dupont. | © Viton is a Registered Trademark of Dupont.

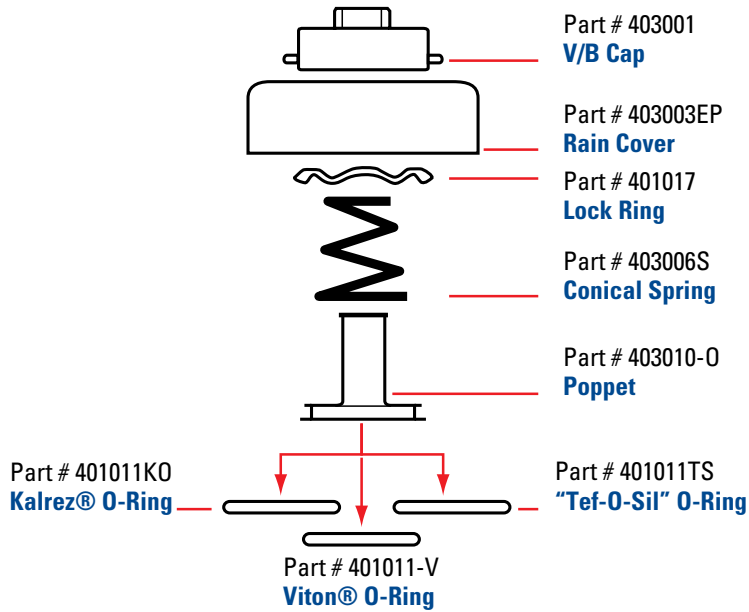

**PERFORMANCE**

Instant opening	at 4" Hg.
Flow rates	12,000 SCFH at 6" Hg.
Test Pressure	Seat is bubble tight on pressures from 0-50 PSIG.
Magnetic Field	Coated magnets. Can not be contaminated by surrounding metals or products being transported.
Teflon®	Suited for all ladings. (Check with the manufacturer).
Kalrez®	Identical chemical properties as Teflon®. Suited for all ladings.
Viton®	Suited for most ladings. Check compatibility.
Special Elastomers are available upon request	

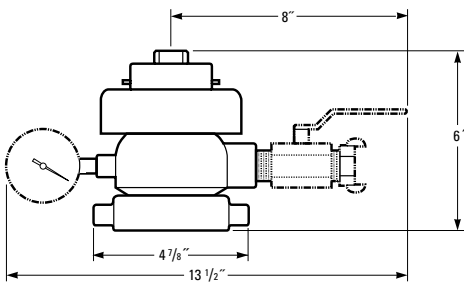

**3X407MVBTX**  
Complete vacuum breaker with a 3" swivel connection. Designed to be attached to a 3" NPT tank trailer nipple.

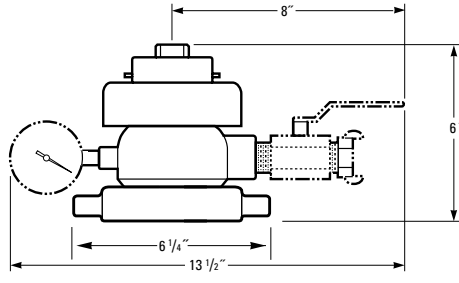

**407MVBLTX**  
Complete vacuum breaker with a 4" swivel connection. Designed to be attached to a 4" NPT tank trailer nipple.

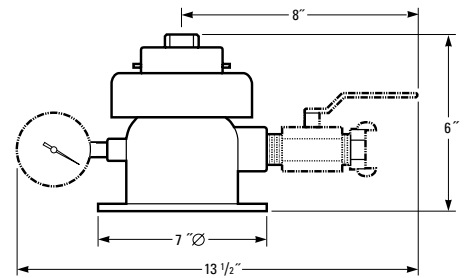

**407MVBFLX**  
Complete vacuum breaker with a 4" TTMA flanged connection. Designed for installation on a tank trailer flanged nozzle.

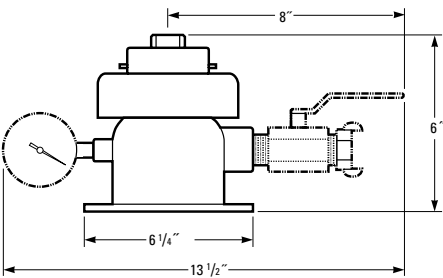

**3X407MVBFX**  
Complete vacuum breaker with a 3" TTMA flanged connection. Designed for installation on a tank trailer flanged nozzle.

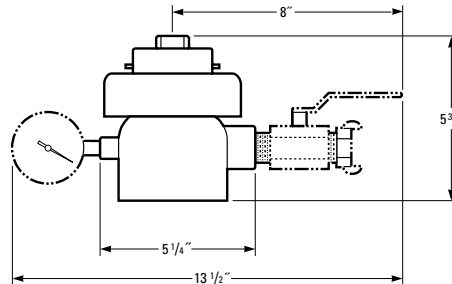

**407MVBLSX**  
Complete vacuum breaker with a straight stub connection. Designed to be welded to either a domecover or the tank shell.

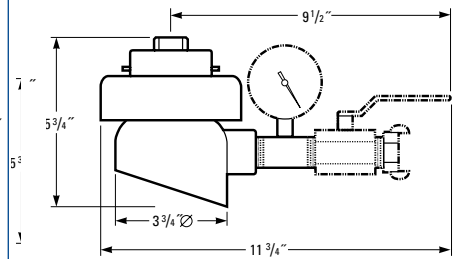

**407MVBMLX**  
Complete vacuum breaker with a mitred connection. Designed to be welded to a domecover and conform to its curvature.