

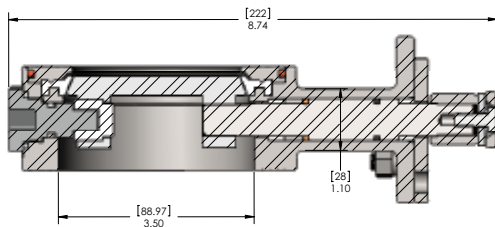

**FEATURES:**

- Designed to be mounted between the two flange faces of a Bottom Outlet Valve and a Spigot Flange
- All parts are 316L Stainless Steel with PTFE seals
- Left hand operation Butterfly Valve with TIR and a security lock facility



**SPECIFICATIONS:**

<b>Weight:</b>	10 lbs. (4.53 kg)
<b>Working Pressure:</b>	6.8 bar (100 psi)

**ORDERING INFORMATION:**

PART NO.	DESCRIPTION
300CSBV	3" Clamped style Butterfly Valve as described above.
GQ70030	Flange gaskets (2 required) when fitted between Foot-valve and 3" Spigot Flange.

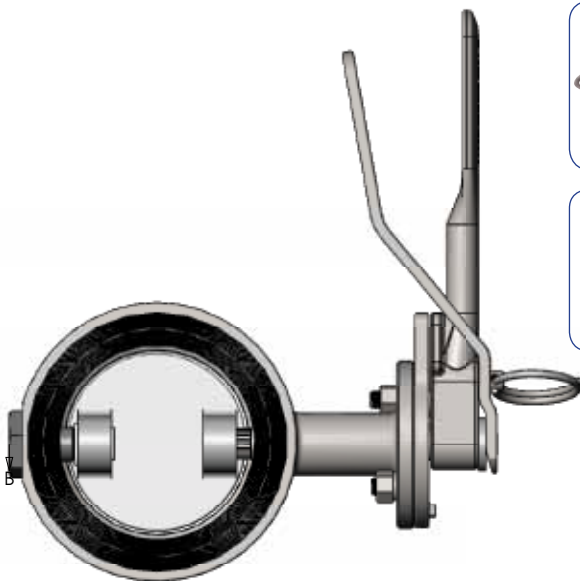

GQ70030  
Butterfly Valve Flange Gaskets



GE-300BK-CFV  
SS Bolt, Nut Washer,  
Nylon Spacers

ITEM #	PART #	DESCRIPTION	QTY.
1	GQ50010	MAIN BODY	1
2	GQ50020	BUTTERFLY SHAFT	1
◆	GQ50030	-113 TEF-O-SIL O-RING	1
◆	GQ50031	-113 VITON O-RING	1
5	GQ50040	DISC	1
◆	GQ50050	SHAFT BUSHING	1
7	GQ50060	SUPPORT SHAFT	1
◆	GQ50070	SEAT TEF-O-SIL O-RING -245	1
9	GQ50080	SEAT RING	1
◆	GQ50090	SHAFT BUSHING	2
11	GQ50091	HANDLE	1
12	GQ50092	HANDLE LEVER	1
13	GQ50101	HANDLE LOCK PLATE	1
14	GQ50160	8mm LOCK WASHER	2
15	GQ50170	8mm WASHER	1
16	GQ50190	M8 NUT	2
17	GQ50200	LEVER SPRING	1
18	GQ50210	LOCK PIN	1
19	GQ50230	PULL RING	1
◆	GQ50250	SHAFT BUSHING TEFLON® O-RING	1
◆	GQ50260	SUPPORT STEM TEFLON® O-RING -117	1
22	GQ50280	SHAFT COLLAR	1
◆	GQ50501	MAIN PTFE SEAT	1
24	GQ60080	WASHER	1
25	93395A407	M8x1.25x25 FLAT HEAD SOCKET CAP SCREW	1
26	GQ101025	HEX HEAD CAP SCREW M6 x 1 x 16	1
27	93635A326	HEX HEAD CAP SCREW M8 x 1.25 x 30	1
28	GQ101018	M6 SPLIT LOCK WASHER	1



3" Blanking Cap (BSP)  
GE-3SC-BSP



GQ70040	3" Spigot Flange (BSP)
GN30360	3" Spigot Flange (NPT)

◆	300CSBV-RK	CLAMPED STYLE BUTTERFLY VALVE REPAIR KIT
---	------------	--

